



OLB CONSTRUCTION

CLASSIC LINE

OLB (One Layer Board), it's a single layer particle board, glued with urea-formaldehyde melamine adhesive by means of a high technology continuous pressing process. This board has been manufactured to be used as a structural solution in construction and remodeling projects*.



SAFE HOME FOR
YOUR FAMILY

www.masisa.com

*Base on technical information provided here.

CLASSICS LINE
Ideal for all types of projects.

MASISA
Your world, your style

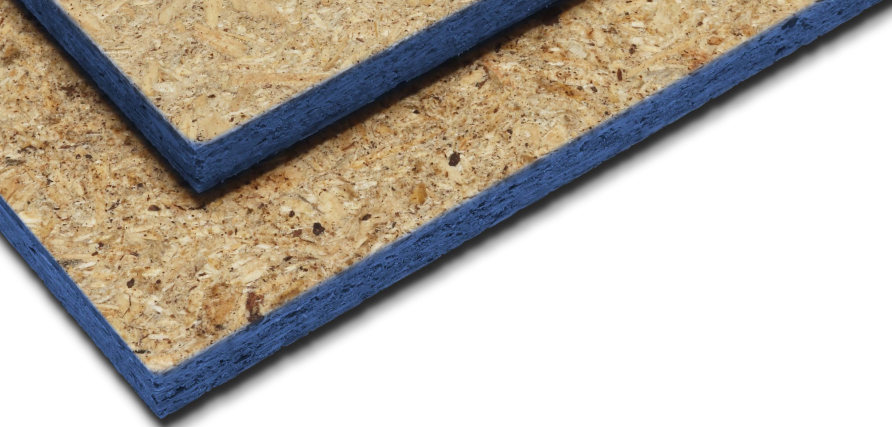

CERTIFICATIONS

TSCA
Title VI



CLASSIC LINE ATTRIBUTES



OLB CONSTRUCTION

COMMON USES

- Used as a structural support* in interior substructure construction
- Used to build perimeter walls as a structural support with covers
- Used in ceilings and roofs*

PRODUCT ATTRIBUTES

- Resistant to humid environments.
- High resistance and dimensional stability.
- Blue edges to check gravity
- Decorative items can be hung on it.
- Standard size that eases use in construction.

PHYSICAL AND MECHANICAL PROPERTIES

PROPERTIES	REFERENTIAL METHOD	MEASURE	UNIT
Thickness	EN 317	[mm]	12 mm \pm 0,5
Density	EN 323	[kg/m]	700 \pm 30
Fending	EN 310	[N/mm]	18 \pm 5
Traction	EN 320	[N/mm]	0,60 \pm 0,1
Swelling in 24 hours	EN 317	[%]	Máx. 25
Moisture	EN 317	-	8 \pm 3
Size	1220 x 2440 mm \pm 2,0 mm/m		

*Ask about other sizes and thickness

MATERIAL

Melamine resin single layer particle board (not sanded) of resin

SIZE	THICKNESS	DENSITY
1220 x 2440 mm	12 mm	700 kg/m ³

RECOMENDATIONS FOR USE AND INSTALLATION

- This is an ideal product to be used in substructures, floors, and ceilings as a structural support, according to technical information provided.
- When used as ceiling, use doble board to make sure to comply the Chilean Standard.
- To attach the OLB to the substructure, use spiral nails or wood screws every 15 cm (5.9 in).
- In order to guarantee durability of the board, make sure that this is not.

RECOMMENDATIONS FOR STORAGE

- Blockings Boards must be stored in a dry, clean and insect free place, protected from extreme weather conditions and rain.
- Stack sheets horizontally, preferably separated from the floor on pallets, installing a waterproof foil before the panels are stacked on it.

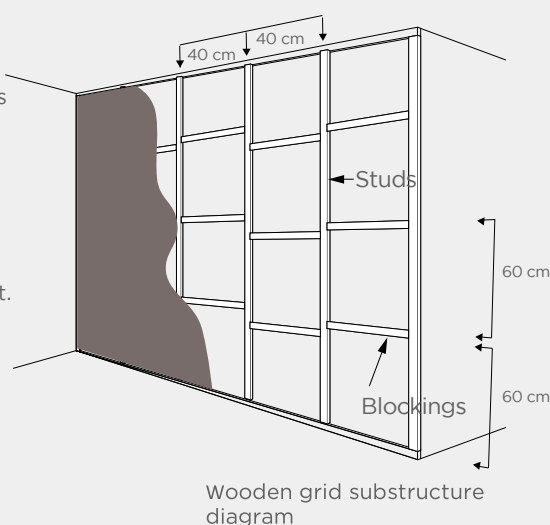

*Base on technical information provided

CLASSICS LINE
Ideal for all types of projects.

MASISA
Your world, your style

MASISA®
Your world, your style

U.S office: 1855 Piedmont Rd. Ste 101 Marietta, GA 30066.
Sales team: masisaua@masisa.com

www.masisa.com

Masisa reserves the right to modify the product properties without prior notice.

Information updated to September 2023.