

# FLUTED ACCENT WALL PAINTED

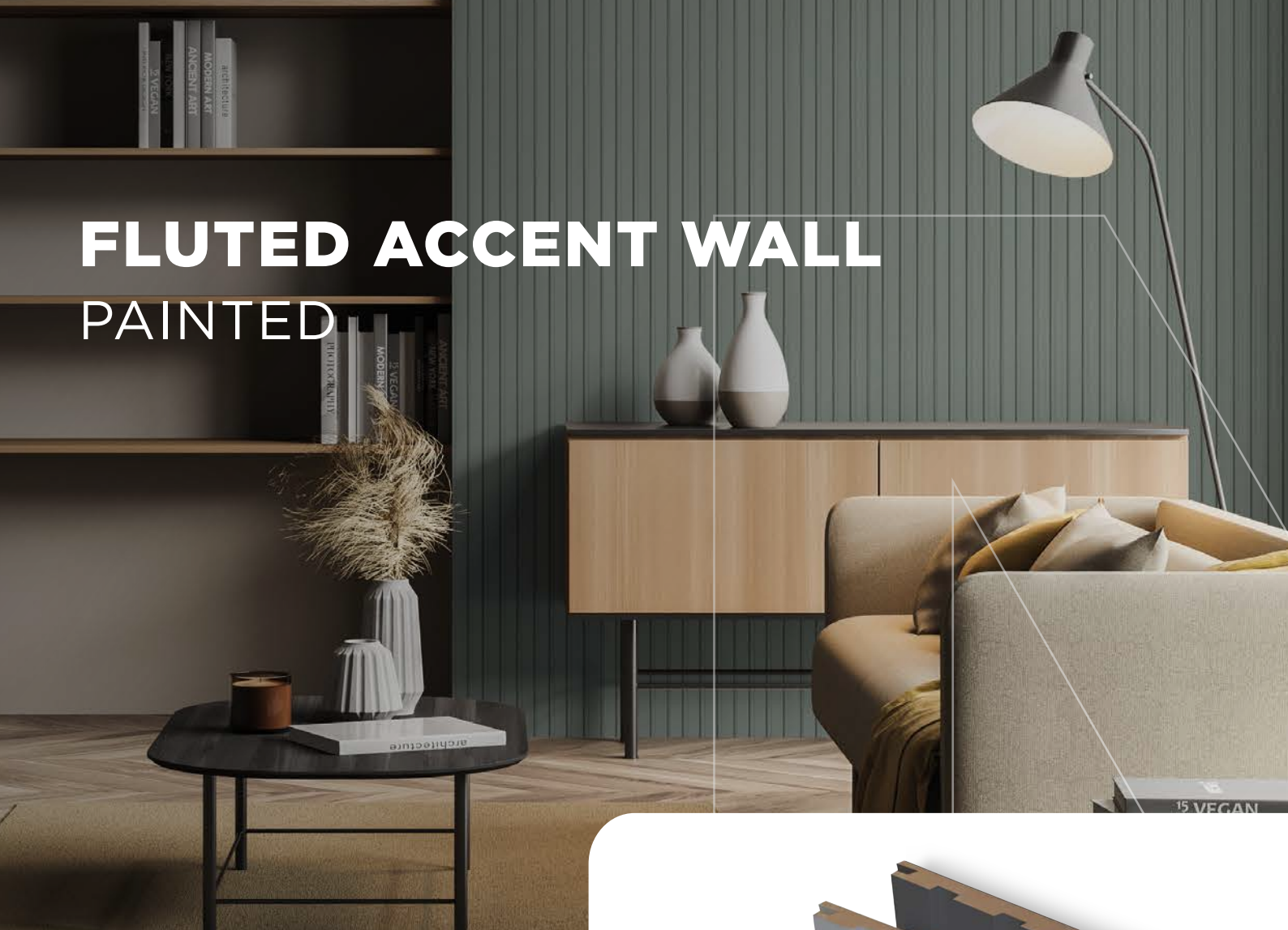

Elevate any room instantly with our decorative panel, boasting sleek grooves and flutes for a modern, elegant touch.

Its easy installation offers a quick way to infuse your space with contemporary sophistication.



## CERTIFICATIONS AND FEATURES



RESPONSIBLE  
PRODUCTION



FINISHED  
PRODUCT



TONGUE & GROOVE  
SYSTEM



QUICK  
INSTALLATION

## FLUTED ACCENT WALL PAINTED

### COMMON USES

Recommended to be used as wall coverings and ceilings, mounted either on wooden or galvanized profiles partitions, masonry or concrete, among others. It is recommended to be used in moisture free areas. This is an ideal product to decorate homes, offices, commercial and institutional spaces, providing a high finish and warmth.

### AVAILABLE DESIGNS

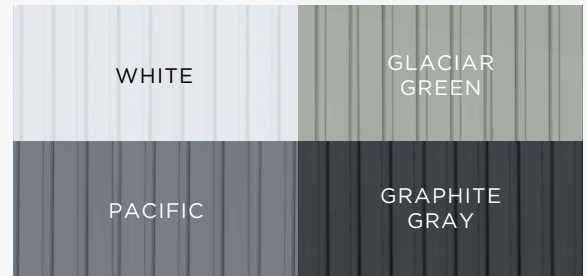

### FEATURES

- Tongue and groove system for easy installation.
- Decorative items, such as mirrors, wall frames and others can be hung on it.
- Final product, it doesn't require any painting or polishing.

#### SIZES

120.1 x 6.2 inches  
or 96 x 6.2 inches\*

#### FINISHED SURFACE

Colored

#### ACTUAL WIDTH

5.9 inches

#### PACKING

4 pieces

#### ACTUAL THICKNESS

0.59 inches

#### JOINT SYSTEM

Tongue and groove system

### EDGE PROFILE

Tongue and groove system

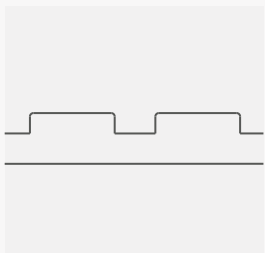

FLUTED

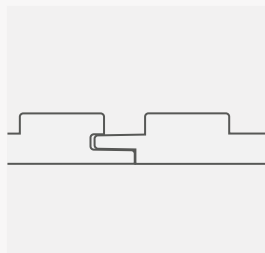

JOINT SYSTEM

FLUTED



6.2 in.

120.1 in.



FLUTED



6.2 in.

96 in.



\* Panel sizes may vary by retailer

**MASISA**

## ASSEMBLY INSTRUCTIONS ON WOOD

### WOODEN FRAMING

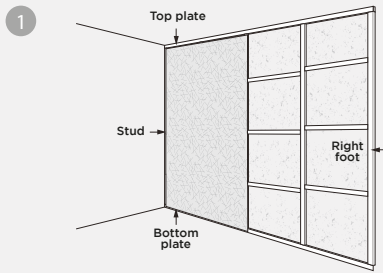

Assemble panels directly onto a wooden frame. For improved leveling, insulation, and stiffness, cover the frame using MDF/MDP board.

### PANEL FIXING



Attach panels with high elasticity adhesive. For extra hold, use 0.13" flat head screws or finishing nails at the edges of fluted panels or on the painted surface of fluted panels.

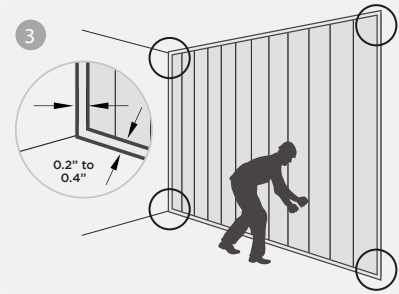

Leave a 0.2" - 0.4" gap around the perimeter. Avoid direct floor installation; maintain at least 0.4" gap to prevent fluid contact.

## ASSEMBLY INSTRUCTIONS ON CONCRETE MASONRY

### WOODEN FRAMING

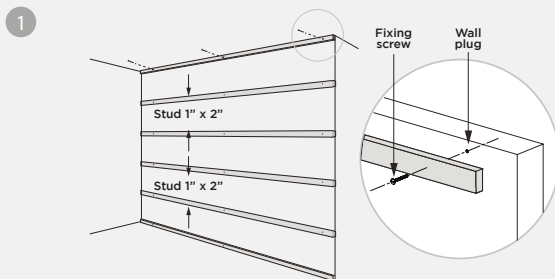

For leveling and insulation, cover walls with MDF's or wood furring strips every 16". Do not install on irregular or humid walls (moisture content should be below 12%)

### PANEL FIXING

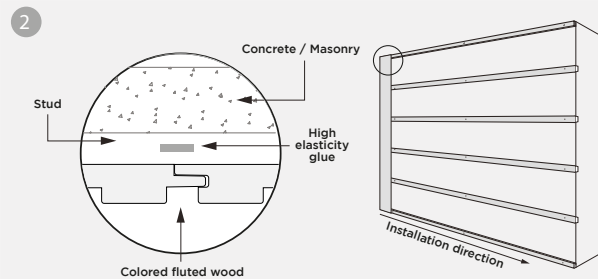

Install wood panels from left to right. Ensure the first piece is level, then secure with adhesive. For added stability, use 0.13" flat head screws or finishing nails at the edges or on the Melamine surface.

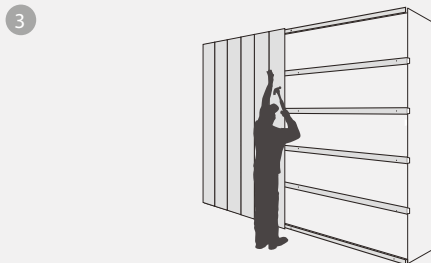

Install additional wood panels using a rubber hammer or wooden block. Avoid striking the shiplap edge directly with the hammer as this could cause damage.

## ASSEMBLY INSTRUCTIONS INSTALLATION TO CEILINGS

To install panels to ceilings, first fix 1" x 2" pine pieces on the base framing, with a gap no wider to 40 cm. Then, install Masisa Ecoplac OLB lining or other surface.

Finally, stick directly on panel with high elasticity adhesive. Fixing must be strenghten with 0.13" flat head screws on edges of Fluted panels or on melamine surface on micro fluted panels.

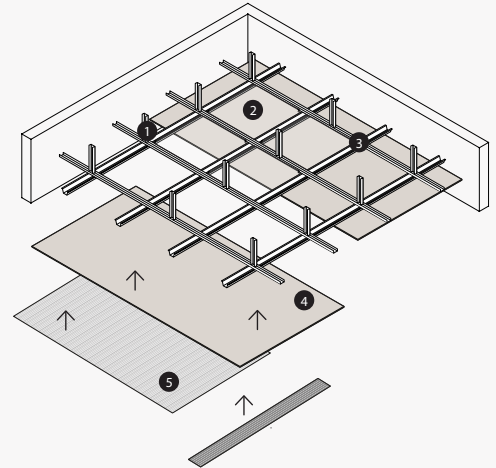

1. Rigid tensor
2. Insulation
3. Mounting profile
4. Ecoplac Masisa lining
5. Fluted or micro fluted panel

## RECOMMENDATION FOR CORNER JOINTS

### OUTER CORNER JOINT

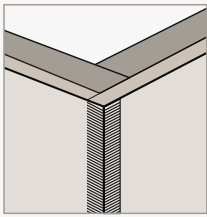

For better finishing and protection, it is recommended to use a aluminum angle of the same thickness as the product.

### INNER CORNER JOINT

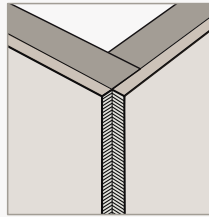

For better finishing and protection, it is recommended to use a aluminum angle of the same thickness as the product.

### SHIPLAP EDGE

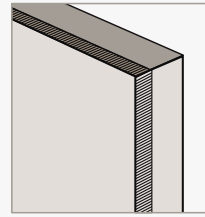

When covering horizontal or vertical edges, it is recommended to use a mill finished aluminium solid of the same thickness as the product at least 0.4" wide or wider if necessary.

## IMPORTANT RECOMMENDATIONS

- It is essential to acclimatize the panels during 48 hours before its mounting and in the place where it will be installed.
- The place where the panel will be installed must be moisture free. In every construction project, it is recommended to install the panel after finishing the construction and when the wet works have been finished.
- It is recommended to install Ecoplac Masisa before lining installation when: Walls are not well leveled. The wood piece shafts are not placed to the required distance. Higher insulation is needed.
- Mounting wall must be clean and smooth before lining installation. Remove any roughness of 0.07" or more.
- When sawing panels, if manual saw is used, make the sawing with the decorative face upwards, and if electric saw is used, make the cut with the decorative face downwards.
- Sawing must be made with a WIDIA disc, 86 teeth with rip blades, following the rotation speed specifications v/s moving speed provided by the manufacturer of each equipment.
- For a correct assemble and joint fixing, floor and wall installation level must be perfect. On the contrary, incorrect joints will be produced.
- If better insulation features are needed for the panels, it is possible to install an insulation product before installing the lining.
- It is recommended to use a mounting addeisive based on polyurethane, with elastic properties, moisture resistant and fast drying.
- 0,2" to 0,4" perimeter gap is recommended per side.
- Do not install direct to floor (due to contact with fluids), considering a gap not less to 0,4".

**MASISA®**

U.S office: 1855 Piedmont Rd. Ste 101 Marietta, GA 30066.  
Sales team: [masisaua@masisa.com](mailto:masisaua@masisa.com)

[www.masisa.com](http://www.masisa.com)

Masisa reserves the right to modify the product properties without prior notice.

**Information updated to June 2024.**